

1. Expand the frame with the adjustable feet pointed down.

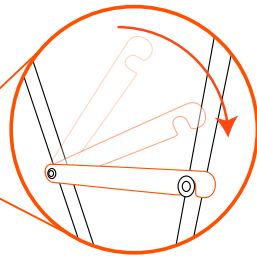

2. Lock the two metal support brackets to secure the frame open.

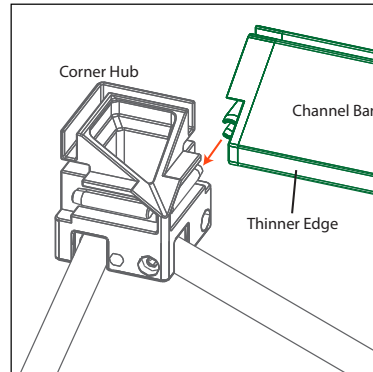

3. Install the 4 front channel bars and rear 4 back channel bars. The thinner edge goes toward the inside of the frame.

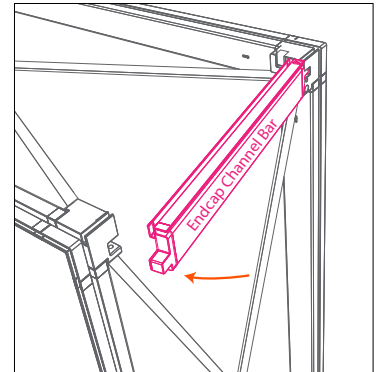

4. Snap the four endcap channel bars to the top and bottom sides of the frame.

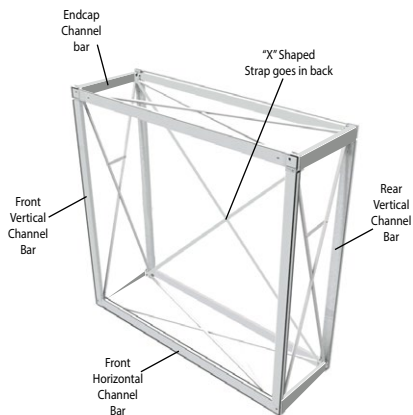
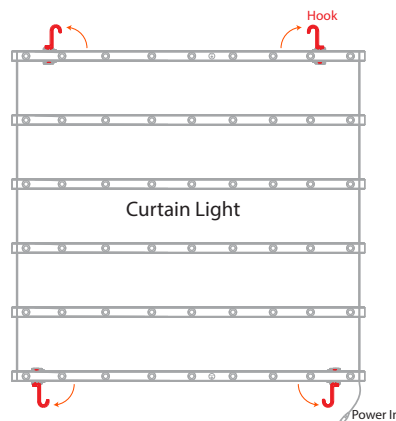
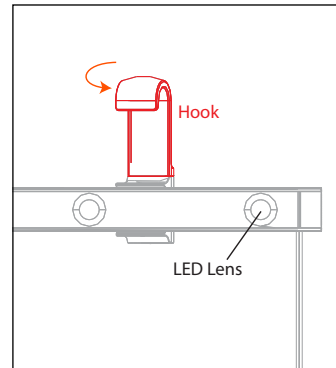

Diagram showing the locations of the channel bars required.



5. Unroll the curtain light and swivel the four hooks 90 degrees.



6. Rotate the hooks to face the same direction as the LED lenses.

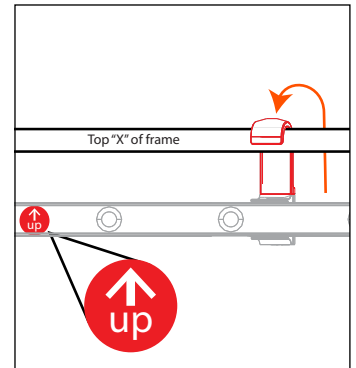

7. With the "up" sticker facing toward the top of the frame, mount the clips to the frame so the hooks are facing the front. Stretch the bottom hooks down and hook them onto the bottom of the frame.



8. Connect the power supply to the bottom of the curtain light. Plug the power cord in and test the lights.



9. Install the front wrap-around graphics and the back graphics. See the following page for detailed graphic installation. Set countertop on top (making sure the frame nubs go into the recesses). Plug the power cord in to light up the display.



## Bag Packing Instructions



## Graphic Installation Instructions



Caution! Installing silicone-edged graphics is technique sensitive; Practice will shorten installation time.



Handle graphics with care with clean hands in a clean environment. Clean cloth or latex gloves are recommended.



How to Install SEG Graphics:

Turn and tuck the side of the graphic with the silicone welt into the SEG groove. The stitched edge goes into the groove first.



Pulling on the silicone welt during installation stretches the silicone and creates a bulge in the silicone welt that is difficult to correct smoothly.

A series of tucks reduces excess silicone.

## Installing Graphics

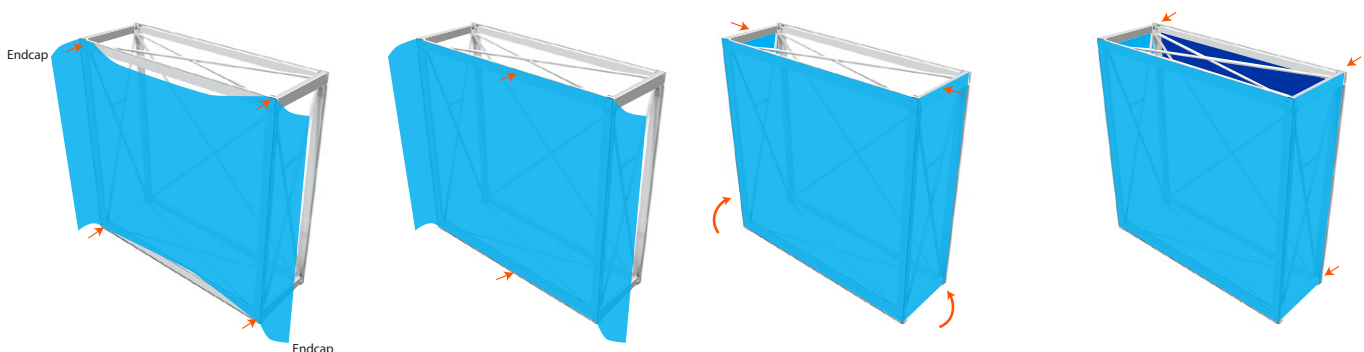

1. Tuck the graphics with wrap-around endcaps into each corner where there is a gap in the silicone welt.

The silicone welt tucks into the SEG groove facing forward from the front of the frame.

2. Complete tucking the front of the graphic.

3. Wrap the endcap around the sides of the counter and tuck into the rear side vertical SEG grooves. Complete endcap installation by tucking the remaining silicone into the SEG grooves.

4. Install the back graphics by first tucking all four corners into the rear-facing SEG grooves. Then, tuck the remaining silicone into the SEG grooves.